

Tallis Vertical Fitting Instructions

Oval Tube Steel Radiator

Please read these instructions and terms and conditions carefully prior to installation. Failure to do so may invalidate the warranty.

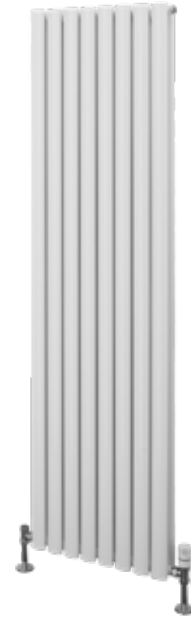

Drawings

Fig 1

Single Tallis

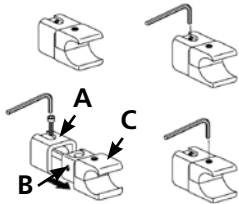

Double Tallis

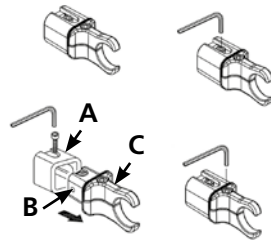
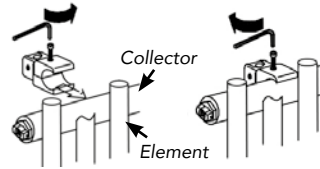

Fig 4

Single Tallis



Double Tallis

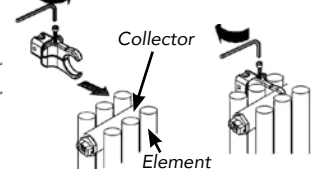

Fig 2

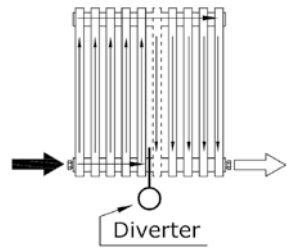
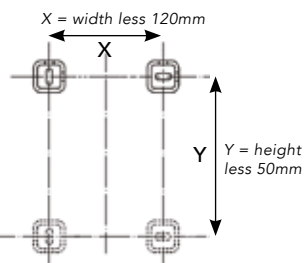
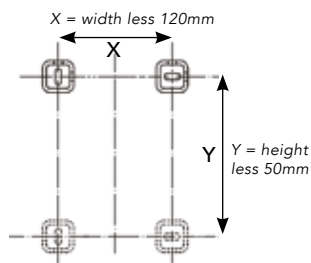

Fig 3

Single Tallis



Double Tallis



Single Tallis

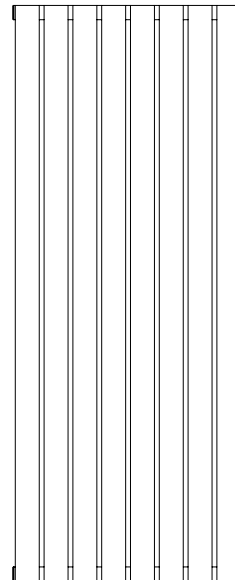

Double Tallis



Pipe Centres

Pipe centres left to right =
Pipe centres from wall =
Depth from wall =

Single

width + valves
55mm
95mm

Double

width + valves
80mm - 90mm
120mm - 130mm

1. Unpack & Inspect

This product should have reached you in perfect condition. Please carefully unpack and inspect this radiator and all fittings. Your point of purchase must be notified of any shortages or damage within 28 days of delivery.

For further information please see terms and conditions at the bottom of the page

2. Contents

You should have:

- 1 Radiator
- 4 Wall Brackets
- 4 Wall Plugs
- 4 Screws
- 4 Wall Sleeves
- 1 Airvent
- 1 Cover for Blanking Plug
- 1 Steel Diverter

You will need:

- Tape measure
- Electric drill and bits
- 1 x 5mm Hex key
- 1 x 8mm Hex key
- Screwdriver
- Spirit level

3. Mark Bracket Positions

1. Mark bracket positions as per **Fig. 3**, measure the width (X) of the radiator less 120mm and the height (Y) of the radiator less 50mm to find your four fixing positions for the Wall sleeves.
2. The Wall Sleeve ("A" in **Fig. 1**) screws into the wall in the positions as described above.
3. Ensure diverter is in the correct position (see section 5).
4. Attach clamps **B & C** to collector between the 2nd and 3rd element from either side, do not overtighten (**Fig. 1**) this, to allow slight adjustment for inserting into wall sleeves.
5. Raise radiator and slot into Wall sleeves "A" and tighten (**Fig. 4**).

4. Fix Brackets

Using a suitable drill bit, screws and plugs, fix the brackets and level with a spirit level.

PLEASE NOTE:

It is essential that all brackets are level and square prior to hanging the radiator to ensure a vertical alignment for connecting the pipework.

5. Identifying diverter

Factory fitted steel diverters are used in all vertical models and can be identified by a sticker found on the underside of one collector. The radiator must be hung with the diverter at the bottom. If this sticker is missing simply look into both collectors, one will have a clear water way and one will have a deliberate blockage, this deliberate blockage is the diverter. Please note the diverter can not be removed.

6. Hang & Commission

With the brackets sleeves firmly fixed and level, the radiator can be hung in position by inserting the brackets into the sleeves and securing with the grub screws provided.

When commissioning your radiator on an indirect/closed system we recommend using a suitable mixed metal inhibitor to protect against scale & corrosion.

Damage caused to systems not protected by a suitable inhibitor will not be covered by manufacturer's guarantee.

PLEASE NOTE: Systems using micro bore pipe work must have adequate pressure and flow rates for the number and style of radiators on the system.

Technical Specifications

Materials	Steel
Connections	½" flow and return.
Test pressure	6 Bar
Testing authority	EN442
Maximum operating pressure	4 Bar
Maximum working temperature	95 °C
Packaging	Wrapped in polythene within cardboard box

Guarantees & Liabilities

This product is guaranteed for 10 years. The guarantee is subject to the products being installed in accordance with British and or European standards as well as these fitting instructions. The guarantee in all cases are restricted to the free of charge replacement or repair of the failed product only. Our liability will under no circumstances extend beyond the repair or replacement of the product supplied by us. Claims for either labour in replacement or damage to property are not admissible. Any goods that are returned, in the event of a problem, will belong to us.

Terms & Conditions

All products must be inspected once removed from the packaging and your point of purchase notified within 28 days of delivery of any scratches, blemishes or other damage. Your point of purchase will then agree appropriate action.

Imperfect radiators should therefore not be fitted and we will not accept responsibility for replacement of scratched or damaged radiators once they have been fitted. This includes any consequential loss or cost of fitting.

If we are not notified within 28 days of the date on the signed delivery note then it will be deemed that we have fully complied with our obligations and claims will not be considered.

Failure to comply with any of the above may invalidate any claims. We recommend that after you check the product on delivery that it is stored in its packaging to prevent damage prior to installation, we cannot accept responsibility for items damaged after delivery. For full details of our Terms and Conditions please visit www.supplies4heat.co.uk or call us on 01342 306880.