

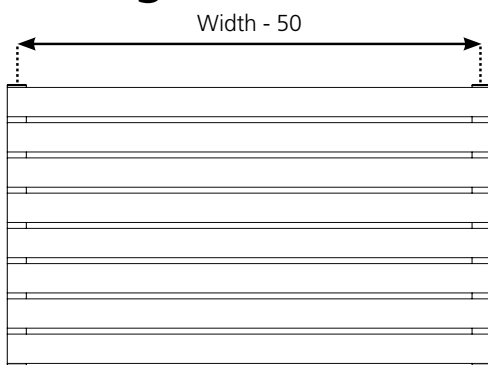
## Tallis Horizontal Fitting Instructions

### Oval Tube Steel Radiator

Please read these instructions and terms and conditions carefully prior to installation. Failure to do so may invalidate the warranty.

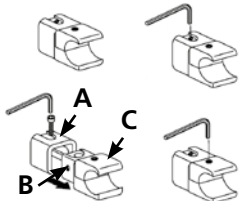


### Drawings

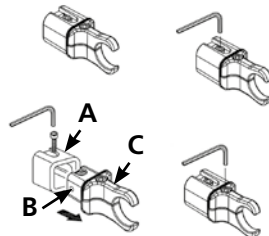


**Fig 1**

Single Tallis

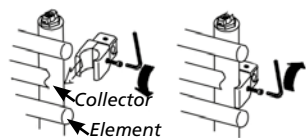


Double Tallis

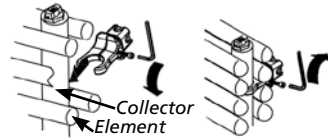


**Fig 3**

Single Tallis



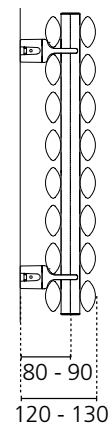
Double Tallis



Single

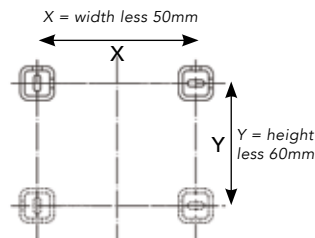


Double

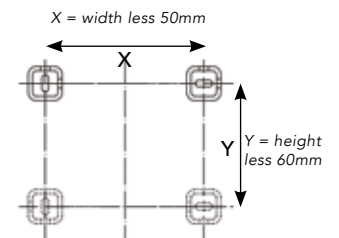


**Fig 2**

Single Tallis



Double Tallis



### Pipe Centres

Pipe centres left to right =  
Pipe centres from wall =  
Depth from wall =

**Single**

width less 50mm  
55mm  
95mm

**Double**

width less 50mm  
80mm - 90mm  
120mm - 130mm

# 1. Unpack & Inspect

This product should have reached you in perfect condition. Please carefully unpack and inspect this radiator and all fittings. Your point of purchase must be notified of any shortages or damage within 28 days of delivery.

For further information please see terms and conditions at the bottom of the page

## 2. Contents

You should have:

- 1 Radiator
- 4 Wall Brackets
- 4 Wall Plugs
- 4 Screws
- 4 Wall Sleeves
- 1 Airvent
- 1 Cover for Blanking Plug

You will need:

- Tape measure
- Electric drill and bits
- 1 x 5mm Hex key
- 1 x 8mm Hex key
- Screwdriver
- Spirit level

## 3. Mark Bracket Positions

1. Mark bracket positions as per *Fig. 2*, measure the width (X) of the radiator less 50mm and the height (Y) of the radiator less 60mm to find your four fixing positions for the Wall sleeves.
2. The Wall Sleeve (**A** in *Fig. 1*) screws into the wall in the positions as described above.
3. Attach clamps **B** & **C** to collector, between the 2nd and 3rd element above and below do not overtighten (*Fig.1*) this, to allow slight adjustment for inserting into wall sleeves.
4. Raise radiator and slot into Wall sleeves "**A**" and tighten (*Fig. 3*).

## 4. Fix Brackets

Using a suitable drill bit, screws and plugs, fix the brackets and level with a spirit level.

**PLEASE NOTE:**

It is essential that all brackets are level and square prior to hanging the radiator to ensure a vertical alignment for connecting the pipework.

## 5. Hang & Commission

With the brackets sleeves firmly fixed and level, the radiator can be hung in position by inserting the brackets into the sleeves and securing with the grub screws provided.

When commissioning your radiator on an indirect/closed system we recommend using a suitable mixed metal inhibitor to protect against scale & corrosion.

**Damage caused to systems not protected by a suitable inhibitor will not be covered by manufacturer's guarantee.**

**PLEASE NOTE:** Systems using micro bore pipe work must have adequate pressure and flow rates for the number and style of radiators on the system.

---

## Technical Specifications

<b>Materials</b>	Steel
<b>Connections</b>	½" flow and return.
<b>Test pressure</b>	6 Bar
<b>Testing authority</b>	EN442
<b>Maximum operating pressure</b>	4 Bar
<b>Maximum working temperature</b>	95 °C
<b>Packaging</b>	Wrapped in polythene within cardboard box

## Guarantees & Liabilities

This product is guaranteed for 10 years. The guarantee is subject to the products being installed in accordance with British and or European standards as well as these fitting instructions. The guarantee in all cases are restricted to the free of charge replacement or repair of the failed product only. Our liability will under no circumstances extend beyond the repair or replacement of the product supplied by us. Claims for either labour in replacement or damage to property are not admissible. Any goods that are returned, in the event of a problem, will belong to us.

## Terms & Conditions

All products must be inspected once removed from the packaging and your point of purchase notified within 28 days of delivery of any scratches, blemishes or other damage. Your point of purchase will then agree appropriate action.

Imperfect radiators should therefore not be fitted and we will not accept responsibility for replacement of scratched or damaged radiators once they have been fitted. This includes any consequential loss or cost of fitting.

If we are not notified within 28 days of the date on the signed delivery note then it will be deemed that we have fully complied with our obligations and claims will not be considered.

Failure to comply with any of the above may invalidate any claims. We recommend that after you check the product on delivery that it is stored in its packaging to prevent damage prior to installation, we cannot accept responsibility for items damaged after delivery. For full details of our Terms and Conditions please visit [www.supplies4heat.co.uk](http://www.supplies4heat.co.uk) or call us on 01342 306880.